

Recording Requested By/Return To:  
Southwest Gas Corporation  
9 South 43rd Avenue  
Mail Code 420-588 kas3  
Phoenix, Arizona 85009



Prepared By	<u>kas3</u>	Reviewed By	<u></u>
Sec.	<u>26</u>	T	<u>1N</u>
		R	<u>2W</u>
County	<u>Maricopa</u>	Meridian	<u>G&amp;SRM</u>
WR No.	<u>N/A</u>	State	<u>Arizona</u>
		LRS No.	<u>13054</u>

For and in consideration of the sum of One Dollar (\$1.00) and other good and valuable consideration, receipt of which is hereby acknowledged, the undersigned, hereinafter referred to as Grantor(s), does hereby grant, convey, quitclaim and release unto **SOUTHWEST GAS CORPORATION**, a California Corporation, its successors, assigns, licensees, and invitees as reasonably necessary to effect the purpose of the easement, hereinafter referred to as Grantee, a perpetual easement for the installation and maintenance of a natural gas pipeline or pipelines and appurtenances, across, over, under and through the following described property, to wit:

together with the right of ingress and egress to and from the said easement and the right to use existing roads for the purpose of constructing, inspecting, repairing, and maintaining said pipeline or pipelines and appurtenances and the removal or replacement of same, in whole or in part, at will.

Grantor agrees that no buildings, structures, fences or trees shall be placed upon, over or under said parcel of land, except for street, road or driveway purposes, which Grantor agrees shall not interfere with Grantee's exercise of the rights herein granted. Grantee agrees to work with due care in the exercise of its rights on the property and to restore it to reasonably the same condition which existed before the work was performed.

Except as provided above, Grantee agrees to pay all direct damages which are caused by the Grantee's exercise of the rights herein granted.

W.R. No.      N/A      LRS No.      13054

**The undersigned hereby affirms that there is no Social Security Number contained in this document submitted for recording.**

**TO HAVE AND TO HOLD** said easement unto Grantee, its successors, assigns, licensees, and invitees, together with all rights granted hereby.

**IN WITNESS WHEREOF**, the duly authorized representative of the undersigned has executed this Grant of Easement this \_\_\_\_\_ day of \_\_\_\_\_, \_\_\_\_\_.

**CITY OF GOODYEAR, an Arizona municipal corporation**

By: \_\_\_\_\_  
Signature

\_\_\_\_\_  
Printed Name and Title

ATTEST:

\_\_\_\_\_  
City Clerk

APPROVED AS TO FORM:

\_\_\_\_\_  
City Attorney

**ACKNOWLEDGEMENT**

STATE OF \_\_\_\_\_ )

COUNTY OF \_\_\_\_\_ )

On \_\_\_\_\_, before me, \_\_\_\_\_, a notary public,

personally appeared \_\_\_\_\_, who proved to me on the basis of satisfactory evidence to be the person(s) whose names(s) is/are subscribed to the within instrument and acknowledged to me that he/she/they executed the same in his/her/their authorized capacity(ies), and that by his/her/their signature(s) on the instrument the person(s), or the entity upon behalf of which the person(s) acted, executed the instrument.

I certify under **PENALTY OF PERJURY** under the laws of the State of \_\_\_\_\_ that the foregoing paragraph is true and correct.

**WITNESS** my hand and official seal.

Signature \_\_\_\_\_ (Seal)

EXHIBIT "A"  
GRANT OF EASEMENT

That part of the Northeast Quarter (NE1/4) of Section 26, Township 1 North, Range 2 West of the Gila and Salt River Meridian, Maricopa County, Arizona, more particularly described as follows:

Commencing at the calculated position of the North Quarter Corner of said Section 26, from which the Maricopa County Aluminum Cap stamped LS#42937 marking the Northeast Corner of said Section 26 bears South 89°38'13" East, a distance of 2,648.37 feet and from which the Brass Cap flush stamped S 1/4 SEC 26 LS#13554 marking the South Quarter Corner of said Section 26 bears South 00°18'12" West, a distance of 5,288.83 feet (Basis of Bearings);

Thence South 00°18'12" West, along the West line of the Northeast Quarter of said Section 26, a distance of 1,063.61 feet to a point on the Southerly right-of-way line of the Union Pacific Railroad;

Thence North 82°05'34" East, along said Southerly right-of-way line, a distance of 14.46 feet;

Thence North 82°03'08" East, along said Southerly right-of-way line, a distance of 41.07 feet to the Point of Beginning;

Thence continuing North 82°03'08" East, along said Southerly right-of-way line, a distance of 14.68 feet to a point on the Easterly right-of-way line of 175th Avenue as described in Document No. 87-187212, Records of Maricopa County, Arizona, said point being on a 935.00 foot radius non-tangent curve, concave Easterly, having a radial bearing of South 84°39'49" West;

Thence Southerly, along said Easterly right-of-way line and along said curve, through a central angle of 02°44'43", a distance of 44.80 feet;

Thence South 00°18'20" West, departing said Easterly right-of-way line, a distance of 29.44 feet;

Thence South 18°07'44" East, a distance of 38.35 feet to a point on said Easterly right-of-way line of 175th Avenue, said point being on a 935.00 foot radius non-tangent curve, concave Easterly, having a radial bearing of South 77°48'56" West;

July 16, 2020

Thence Southerly, along said Easterly right-of-way line and along said curve, through a central angle of  $17^{\circ}22'01''$ , a distance of 283.41 feet to a point on the Northwesterly right-of-way line of Maricopa County Highway 85, as described in Book 4 of Road Maps, Page 22, Records of Maricopa County, Arizona, said point being on a 5,779.58 foot radius non-tangent curve, concave Southeasterly, having a radial bearing of North  $29^{\circ}02'03''$  West;

Thence Southwesterly, along said Northwesterly right-of-way line and along said curve, through a central angle of  $00^{\circ}08'55''$ , a distance of 15.00 feet to a point on a 950.00 foot radius non-tangent curve, concave Northeasterly, having a radial bearing of South  $60^{\circ}27'20''$  West;

Thence Northwesterly, departing said Northwesterly right-of-way line along said curve, through a central angle of  $10^{\circ}58'38''$ , a distance of 182.01 feet;

Thence North  $18^{\circ}07'44''$  West, a distance of 145.70 feet;

Thence North  $00^{\circ}18'20''$  East, a distance of 75.04 feet to the Point of Beginning.

Containing 6,594 Square Feet or 0.151 Acres, more or less.

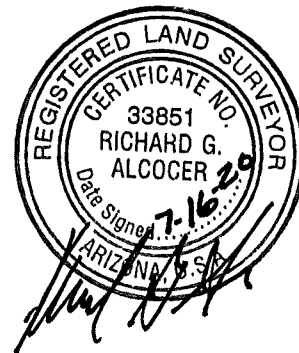

POINT OF COMMENCEMENT  
NORTH 1/4 CORNER,  
SECTION 26,  
TOWNSHIP 1 NORTH,  
RANGE 2 WEST

S89°38'13"E 2648.37'

NORTHEAST CORNER  
SECTION 26

UNION PACIFIC  
RAILROAD

POINT OF BEGINNING

S84°39'50"W(R)

(BASIS OF BEARINGS)  
S00°18'12"W 5288.83'

4225.22'

S77°49'01"W(R)

APN 502-49-020L  
BT GOODYEAR LLC  
DOCUMENT NO.  
2005-1810703  
NOT A PART

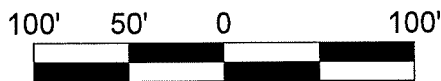

SCALE: 1" = 100'

SOUTH 1/4 CORNER  
SECTION 26

175TH AVENUE  
DOCUMENT NO.  
87-187212

MARICOPA COUNTY  
HIGHWAY 85  
BOOK 4 OF ROAD MAPS  
PAGE 22

S60°27'24"W(R)  
N29°02'04"W(R)

PREPARED BY: COE & VAN LOO CONSULTANTS, INC.

**SOUTHWEST GAS  
CORPORATION**

**EXHIBIT "B"**

OWNER: CITY OF GOODYEAR  
SEC 26 T 1N R 2W G&SRM  
MARICOPA COUNTY, ARIZONA  
DATE: 07/16/2020

APN UNASSESSED SHEET 1 OF 2

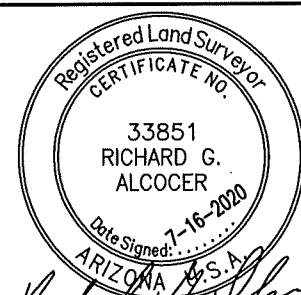

CURVE TABLE					
NO.	LENGTH	RADIUS	DELTA	CHORD	CHORD-BEARING
C1	44.80'	935.00'	002°44'43"	44.79'	S06°42'33"E
C2	283.41'	935.00'	017°22'01"	282.33'	S20°52'04"E
C3	15.00'	5779.58'	000°08'55"	15.00'	S60°53'29"W
C4	182.01'	950.00'	010°58'38"	181.73'	N24°03'21"W

LINE TABLE		
NO.	BEARING	LENGTH
L1	N82°05'34"E	14.46'
L2	N82°03'08"E	41.07'
L3	N82°03'08"E	14.68'
L4	S00°18'20"W	29.44'
L5	S18°07'44"E	38.35'
L6	N18°07'44"W	145.70'
L7	N00°18'20"E	75.04'

PREPARED BY: COE & VAN LOO CONSULTANTS, INC.

<b>SOUTHWEST GAS CORPORATION</b>	<b>EXHIBIT "B"</b>
OWNER: CITY OF GOODYEAR	
SEC 26 T 1N R 2W G&SRM	
MARICOPA COUNTY, ARIZONA	
DATE: 07/16/2020	
APN UNASSESSED	SHEET 2 OF 2

