

EXHIBIT "A"
LEGAL DESCRIPTION OF A
PORTION OF SARIVAL AVENUE ABANDONMENT

All that certain lot, tract, or parcel of land, situated in a portion of the East half of Section 24, Township 2 North, Range 2 West and a portion of the West half of Section 19, Township 2 North, Range 1 West of the Gila and Salt River Base and Meridian, Maricopa County, Arizona, and being more completely described as follows, to-wit:

COMMENCING at a found City of Goodyear bass cap for the Southeast corner of said Section 24, same being the Southwest corner of said Section 19, from which a found Maricopa County of Department of Transportation aluminum cap for the East Quarter corner of Section 24, same being the West Quarter corner of Section 19 bears North 00 deg. 15 min. 08 sec. East (Basis of Bearings) – 2629.83;

THENCE North 00 deg. 15 min. 08 sec. East along the East line of the Southeast Quarter of said Section 24, same being the West line of the Southwest Quarter of said Section 19, a distance of 2283.41 feet to the TRUE POINT OF BEGINNING;

THENCE North 89 deg. 45 min. 08 sec. West departing said East and West lines, a distance of 33.00 feet;

THENCE North 00 deg. 15 min. 08 sec. East being 33.00 feet West of and parallel to the East line of the Southeast Quarter of said Section 24, a distance of 346.41 feet;

THENCE North 00 deg. 12 min. 43 sec. East being 33.00 feet West of and parallel to the East line of the Northeast Quarter of said Section 24, a distance of 1707.34 feet to a Point of Curvature of a non-tangent circular curve to the left, having a radius of 1165.00 feet, a central angle of 10 deg. 12 min. 32 sec., and being subtended by a chord which bears South 18 deg. 21 min. 09 sec. East - 207.30 feet;

THENCE in a southeasterly direction along said curve to the left, at 117.31 feet pass the East line of the Northeast Quarter of said Section 24, from which a found City of Goodyear brass cap for the Northeast corner of said Section 24, same being the Northwest corner of said Section 19 bears North 00 deg. 12 min. 43 sec. East – 1046.27 feet, and continue a total distance of 207.58 feet;

THENCE South 00 deg. 12 min. 43 sec. West being 33.00 feet East of and parallel to the West line of the Northwest Quarter of said Section 19, a distance of 1510.85 feet;

THENCE South 00 deg. 15 min. 08 sec. West being 33.00 feet East of and parallel to the West line of the Southwest Quarter of said Section 19, a distance of 346.43 feet;

THENCE North 89 deg. 45 min. 08 sec. West, a distance of 33.00 feet to the POINT OF BEGINNING, containing 128,425 square feet or 2.948 acres of land, more or less.

Exhibit attached and made a part hereof.

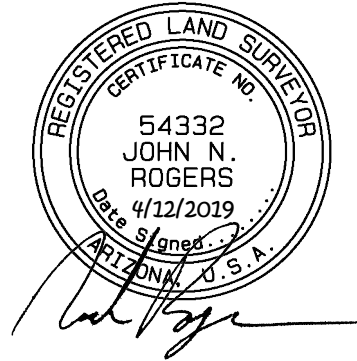

GRAPHIC SCALE 1"=400'



FND. CITY OF GOODYEAR
BRASS CAP IN HANDHOLE
NE COR. OF SEC. 24, T2N, R2W

TRACT A PER
BK. 1260, PG. 15, MCR

N00°12'43"E
2641.10'

SEC. 24, T2N, R2W

LOT 3B PER
BK. 1322, PG. 39, MCR

66.00' DEDICATED COUNTY ROAD PER
BK. 6 OF ROAD MAPS, PG. 27, MCR
AND COUNTY ROAD PER BK. 4 OF
ROAD MAPS, PG. 44, MCR

LOT 4B PER
BK. 1322,
PG. 39, MCR

R=1165.00'
L=207.58'
Δ= 10°12'32"
CB=S18°21'09"E
C=207.30'

130' R/W
PEBBLECREEK PARKWAY
BK. 1260, PG. 15, MCR
TRACT B PER
BK. 1260, PG. 15, MCR

LINE TABLE

| LINE | BEARING | DISTANCE |
|------|-------------|----------|
| L1 | N89°45'08"W | 33.00' |
| L2 | N00°15'08"E | 346.41' |
| L3 | S00°15'08"W | 346.43' |
| L4 | N89°45'08"W | 33.00' |



FND. M.C.D.O.T. ALUMINUM CAP
EAST 1/4 COR. OF SEC. 24, T2N, R2W

LOT 3A PER
BK. 1322, PG. 39, MCR

**POINT OF
BEGINNING**

50' R/W
WEST SELLS DRIVE

BK. 1268, PG. 15, MCR

N00°15'08"E
2629.83'

FND. CITY OF GOODYEAR
BRASS CAP IN HANDHOLE
SE COR. OF SEC. 24, T2N, R2W

SARIVAL
AVENUE

**POINT OF
COMMENCING**

SHEET 3 OF 3

EXHIBIT "A" MAP PORTION OF SARIVAL AVENUE ABANDONMENT

**GOODWIN AND
MARSHALL INC.**

CIVIL ENGINEERS ~ PLANNERS ~ SURVEYORS

2705 S. Alma School Rd., Suite 2, Chandler, AZ 85286
(602) 218-7285

Scale: 1" = 400'

Date: 4/11/2019

Job No.: 10455A

Drafted: J.N.R.

Checked: R.D.H.

