

EXHIBIT "A"  
LEGAL DESCRIPTION FOR  
**PARTIAL RIGHT-OF-WAY ABANDONMENT**  
**WEST MOUNTAIN VISTA DRIVE**

All that certain lot, tract, or parcel of land, situated in a portion of the Northwest Quarter of Section 34, Township 1 South, Range 2 West of the Gila and Salt River Base and Meridian, Maricopa County, Arizona, and being more completely described as follows, to-wit:

**COMMENCING** at a found GLO brass cap for the Northwest corner of said Section 34, same being the Southwest corner of Section 27, Township 1 South, Range 2 West, from which a found GLO brass cap for the West Quarter corner of said Section 27 bears North 0 deg. 13 min. 25 sec. East (Basis of Bearings) - 2634.80 feet;

**THENCE** South 69 deg. 4 min. 16 sec. East departing said Section lines, a distance of 2000.09 feet to a point in the North right-of-way line of West Mountain Vista Drive as shown in the Map of Dedication recorded in Book 1059 of Maps, Page 15, MCR, said point being the **TRUE POINT OF BEGINNING**;

**THENCE** North 77 deg. 2 min. 57 sec. East along said North right-of-way line, a distance of 80.00 feet;

**THENCE** South 57 deg. 57 min. 3 sec. East along said North right-of-way line, a distance of 16.97 feet;

**THENCE** South 77 deg. 3 min. 0 sec. West departing said North right-of-way line, a distance of 104.00 feet to the North right-of-way line of said West Mountain Vista Drive;

**THENCE** North 32 deg. 2 min. 57 sec. East along said North right-of-way line, a distance of 16.97 feet to the **POINT OF BEGINNING**, containing 1,104 square feet or 0.025 acres of land, more or less.

Exhibit map attached and made a part hereof.

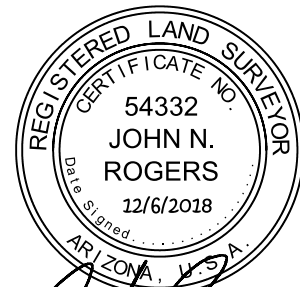

FND. GLO BRASS CAP  
W 1/4 COR. SEC. 27  
T1S, R2W

N 00°13'25"E 2634.80'  
BASIS OF BEARINGS

## POINT OF COMMENCING

FND. GLO BRASS CAP  
NW COR. SEC. 34  
SW COR. SEC. 27  
T1S, R2W

LINE TABLE		
LINE #	BEARING	DISTANCE
L1	N77°02'57"E	80.00
L2	S57°57'03"E	16.97
L3	S77°03'00"W	104.00
L4	N32°02'57"E	16.97

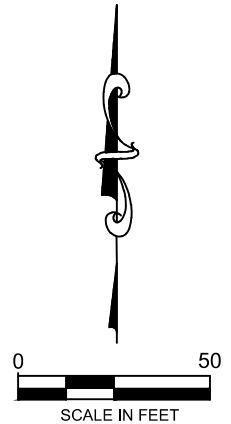

NNP III ESTRELLA MOUNTAIN RANCH LLC  
2013-0589950, MCR

## POINT OF BEGINNING

S 69°04'16"E 2000.09'

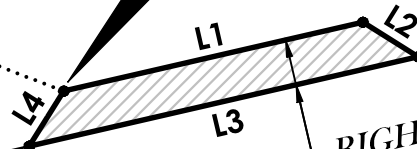

RIGHT-OF-WAY ABANDONMENT  
1,104 SQ. FT. / 0.025 AC.

**WEST MOUNTAIN VISTA DRIVE**  
(BK. 1059 OF MAPS, PG. 15, MCR)

NNP III ESTRELLA MOUNTAIN RANCH LLC  
2013-0589950, MCR

**EXHIBIT "A" MAP SHOWING  
PARTIAL RIGHT-OF-WAY ABANDONMENT FOR WEST  
MOUNTAIN VISTA DRIVE, SITUATED IN A PORTION  
OF THE NORTHWEST QUARTER OF SECTION 34, T1S, R2W  
OF THE G.&S.R.B.&M., MARICOPA COUNTY, ARIZONA**

**GOODWIN AND  
MARSHALL INC.**

CIVIL ENGINEERS ~ PLANNERS ~ SURVEYORS

2705 S. Alma School Road, Suite 2  
Chandler, Arizona 85044  
(602) 218-7285

Scale: 1" = 50'  
Date: 12/6/2018  
Job No.: 10799A  
Drafted: D.M.D.  
Checked: J.N.R.

Sheet  
2  
of  
2

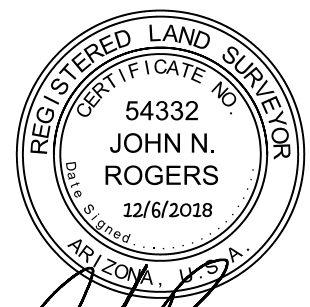

*Handwritten signature of John N. Rogers*