

May 22, 2018
Rick No. 4684B
MEC

LEGAL DESCRIPTION
PARCEL 4

ALL THAT CERTAIN LOT, TRACT, OR PARCEL OF LAND, SITUATED IN A PORTION OF THE SOUTHEAST QUARTER OF SECTION 10, TOWNSHIP 1 NORTH, RANGE 2 WEST OF THE GILA AND SALT RIVER BASE AND MERIDIAN, MARICOPA COUNTY, ARIZONA, AND BEING MORE COMPLETELY DESCRIBED AS FOLLOWS, TO-WIT:

COMMENCING AT A FOUND ALUMINUM CAP FLUSH AT THE WEST QUARTER CORNER OF SAID SECTION 10, FROM WHICH A FOUND BRASS CAP IN HANDHOLE AT THE EAST QUARTER CORNER OF SAID SECTION 10 BEARS SOUTH 89 DEGREES 29 MINUTES 21 SECONDS EAST, 5289.26 FEET;

THENCE SOUTH 89 DEGREES 29 MINUTES 21 SECONDS EAST, ALONG THE EAST-WEST MID-SECTION LINE OF SAID SECTION 10, A DISTANCE OF 1229.91 FEET TO THE TRUE POINT OF BEGINNING;

THENCE SOUTH 89 DEGREES 29 MINUTES 21 SECONDS EAST, CONTINUING ALONG SAID EAST-WEST MID-SECTION LINE, A DISTANCE OF 1350.26 FEET;

THENCE SOUTH 00 DEGREES 30 MINUTES 39 SECONDS WEST, DEPARTING SAID MID-SECTION LINE, A DISTANCE OF 30.00 FEET;

THENCE SOUTH 44 DEGREES 31 MINUTES 52 SECONDS EAST, A DISTANCE OF 46.70 FEET;

THENCE SOUTH 00 DEGREES 25 MINUTES 37 SECONDS WEST, BEING 30.00 FEET WEST OF AND PARALLEL WITH THE NORTH-SOUTH MID-SECTION LINE OF SAID SECTION 10, A DISTANCE OF 557.82 FEET;

THENCE SOUTH 45 DEGREES 30 MINUTES 59 SECONDS WEST, A DISTANCE OF 28.12 FEET;

NORTH 89 DEGREES 30 MINUTES 48 SECONDS WEST, A DISTANCE OF 13.08 FEET;

THENCE SOUTH 00 DEGREES 25 MINUTES 37 SECONDS WEST, BEING 63.00 FEET WEST OF AND PARALLEL WITH SAID NORTH-SOUTH MID-SECTION LINE, A DISTANCE OF 32.50 FEET;

THENCE SOUTH 89 DEGREES 30 MINUTES 48 SECONDS EAST, A DISTANCE OF 11.56 FEET;

THENCE SOUTH 77 DEGREES 04 MINUTES 50 SECONDS EAST, A DISTANCE OF 12.16 FEET TO A POINT OF CURVATURE OF A CIRCULAR CURVE TO THE RIGHT, HAVING A RADIUS OF 5.00 FEET, A CENTRAL ANGLE OF 156 DEGREES 32 MINUTES 06 SECONDS, AND BEING SUBTENDED BY A CHORD WHICH BEARS SOUTH 01 DEGREES 11 MINUTES 13 SECONDS WEST, 9.79 FEET;

THENCE IN A SOUTHERLY DIRECTION ALONG SAID CURVE TO THE RIGHT, A DISTANCE OF 13.66 FEET;

THENCE SOUTH 79 DEGREES 27 MINUTES 16 SECONDS WEST, TANGENT TO SAID CURVE, A DISTANCE OF 13.55 FEET;

THENCE NORTH 89 DEGREES 30 MINUTES 48 SECONDS WEST, A DISTANCE OF 10.00 FEET;

THENCE SOUTH 00 DEGREES 25 MINUTES 37 SECONDS WEST, BEING 63.00 FEET WEST OF AND PARALLEL WITH SAID NORTH-SOUTH MID-SECTION LINE, A DISTANCE OF 32.50 FEET;

THENCE SOUTH 89 DEGREES 30 MINUTES 48 SECONDS EAST, A DISTANCE OF 13.00 FEET;

THENCE SOUTH 44 DEGREES 32 MINUTES 35 SECONDS EAST, A DISTANCE OF 28.30 FEET;

THENCE SOUTH 00 DEGREES 25 MINUTES 37 SECONDS WEST, BEING 30.00 FEET WEST OF AND PARALLEL WITH SAID NORTH-SOUTH MID-SECTION LINE, A DISTANCE OF 548.95 FEET TO THE NORTH LINE OF THE SOUTH 1354.38 FEET OF THE SOUTHWEST QUARTER OF SAID SECTION 10;

THENCE NORTH 89 DEGREES 30 MINUTES 48 SECONDS WEST, ALONG SAID NORTH LINE, A DISTANCE OF 1314.31 FEET;

THENCE NORTH 00 DEGREES 29 MINUTES 12 SECONDS EAST, A DISTANCE OF 460.24 FEET;

THENCE NORTH 89 DEGREES 30 MINUTES 48 SECONDS WEST, A DISTANCE OF 120.47 FEET;

THENCE NORTH 45 DEGREES 58 MINUTES 11 SECONDS WEST, A DISTANCE OF 16.53 FEET TO A POINT OF CURVATURE OF A NON-TANGENT CIRCULAR CURVE TO THE RIGHT, HAVING A RADIUS OF 2975.00 FEET, A CENTRAL ANGLE OF 05 DEGREES 48 MINUTES 31 SECONDS, AND BEING SUBTENDED BY A CHORD WHICH BEARS NORTH 00 DEGREES 28 MINUTES 42 SECONDS EAST, 301.48 FEET;

THENCE IN A NORTHERLY DIRECTION ALONG SAID CURVE TO THE RIGHT, A DISTANCE OF 301.61 FEET;

THENCE NORTH 46 DEGREES 56 MINUTES 05 SECONDS EAST, NON-TANGENT TO SAID CURVE, A DISTANCE OF 16.54 FEET;

THENCE SOUTH 89 DEGREES 30 MINUTES 48 SECONDS EAST, A DISTANCE OF 120.52 FEET;

THENCE NORTH 00 DEGREES 29 MINUTES 12 SECONDS EAST, A DISTANCE OF 390.58 FEET;

THENCE NORTH 44 DEGREES 33 MINUTES 48 SECONDS WEST, A DISTANCE OF 99.29 FEET;

THENCE NORTH 00 DEGREES 30 MINUTES 39 SECONDS EAST, A DISTANCE OF 45.00 FEET TO THE POINT OF BEGINNING, CONTAINING 1,739,477 SQUARE FEET OR 39.933 ACRES OF LAND, MORE OR LESS.

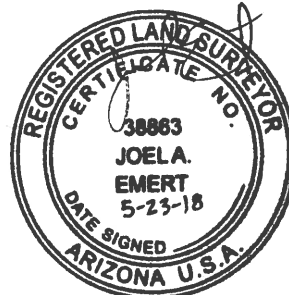

EXPIRES: 03-31-2018