

AMENDED ASSESSMENT DIAGRAM

For
Estrella Mountain Ranch Community Facilities District
(City of Goodyear, Arizona)

MONTECITO ASSESSMENT DISTRICT

ASSESSMENT NUMBER 040 (PARCEL 9.1)

"Coronado Village at Estrella Mountain Ranch Parcel 9.1"
Book 1367, Page 1 (MCR)

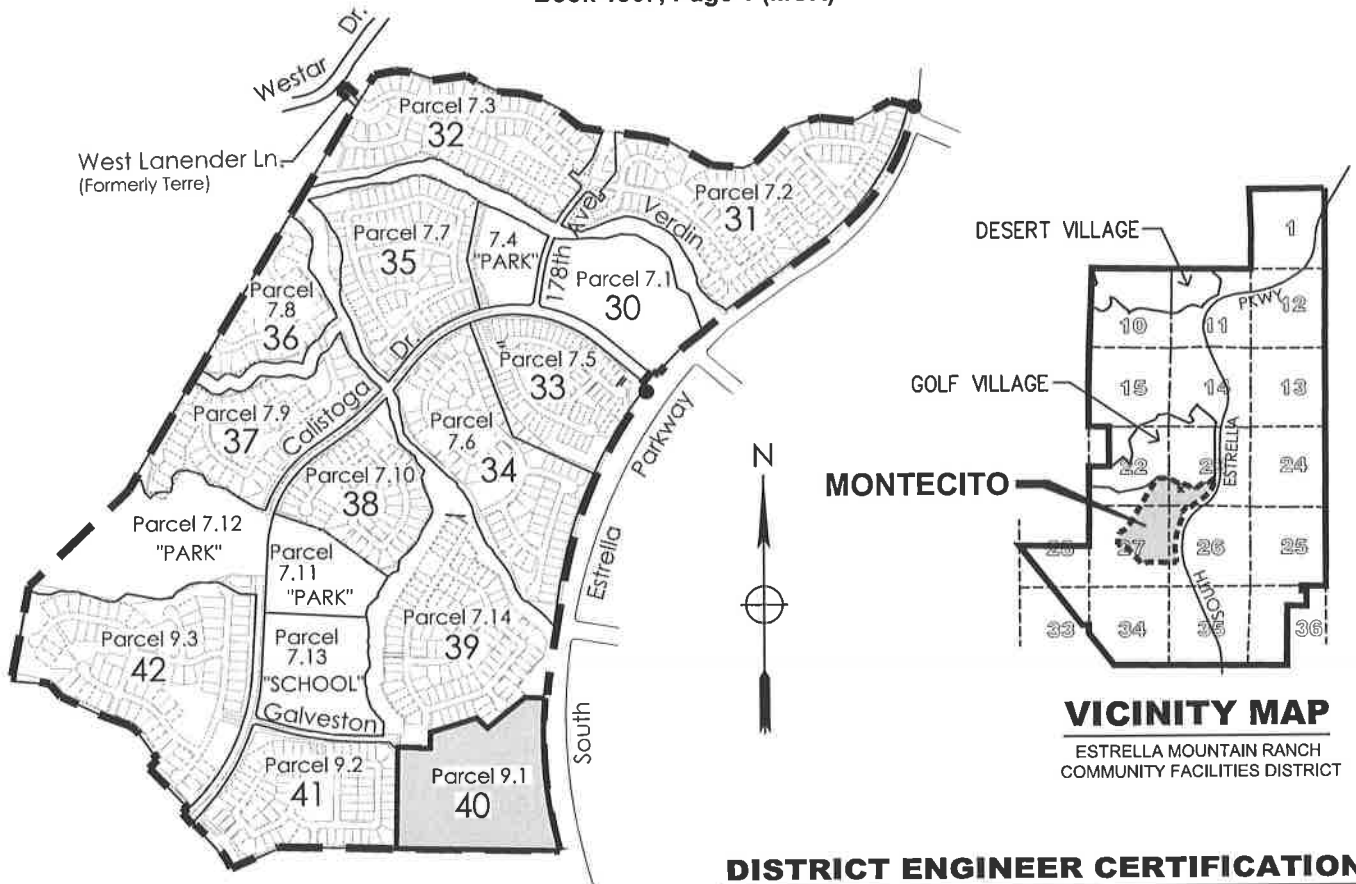

DESCRIPTION

A PORTION OF SECTIONS 22, 23, 26 AND 27, TOWNSHIP 1 NORTH, RANGE 3 WEST OF THE GILA AND SALT RIVER BASE AND MERIDIAN, MARICOPA COUNTY, ARIZONA.

LEGEND

--- MONTECITO DISTRICT BOUNDARY

39

ASSESSMENT NUMBER

ASSESSMENT NO.	PARCEL	LOTS	ACREAGE
30	7.1	126	16.49
031-01-001 thru 126	7.2	88	39.91
032-01-001 thru 086	7.3	88	27.84
	7.4	PARK	7.30
033-01-001 thru 110	7.5	110	17.93
034-01-001 thru 083	7.6	83	30.28
035-01-001 thru 091	7.7	91	27.75
036-01-001 thru 027	7.8	27	12.13
037-01-001 thru 045	7.9	45	23.28
038-01-001 thru 054	7.10	54	17.44
	7.11	PARK	10.5
	7.12	PARK	21.85
	7.13	SCHOOL	15.00
39	7.14	92	27.74
040-01-001 thru 092	9.1	92	22.92
041-01-001 thru 067	9.2	67	25.06
042-01-001 thru 084	9.3	84	41.32
033-02-001 thru 065	7.5	65	-

NOTE: Lot Layout Shown on following Sheet (s)

DISTRICT ENGINEER CERTIFICATION

I HEREBY CERTIFY THAT THE PARCEL BOUNDARIES SHOWN ARE DEPICTED ON THIS PLAN WERE SUPPLIED BY ENTELLUS AND ARE CORRECT TO THE BEST OF MY KNOWLEDGE AND BELIEF.

ENGINEER

DATE

APPROVED BY RESOLUTION NO. _____ AT A MEETING OF THE BOARD OF DIRECTORS OF THE ESTRELLA MOUNTAIN RANCH COMMUNITY FACILITIES DISTRICT, GOODYEAR, ARIZONA ON THE _____ DAY OF _____ 2018

DISTRICT CLERK

DATE

SIGNED: THIS _____ DAY OF _____, 2018

SUBMITTED:

SUPERINTENDENT OF STREETS

DATE



AMENDED ASSESSMENT DIAGRAM

For
Estrella Mountain Ranch Community Facilities District
(City of Goodyear, Arizona)

MONTECITO ASSESSMENT DISTRICT

ASSESSMENT NUMBER 040 (PARCEL 9.1)

"Coronado Village at Estrella Mountain Ranch Parcel 9.1"
Book 1367, Page 1 (MCR)



ASSESSMENT NO.
040-01-001 Through 040-01-092