

- ☐ Barrier Exemption: an exception to the requirement of barriers surrounding a patio/outdoor serving area may be requested. Barrier exemptions are granted based on public safety, pedestrian traffic, and other factors unique to a licensed premises. List specific reasons for exemption:

☐ Approval ☐ Disapproval by **DLLC**: _____ Date: ____/____/____

Notary

I, (Signature) Ryan Witner Anderson , hereby declare that I am a **CONTROLLING PERSON/ AGENT** filing this notification. I have read this document and the contents and all statements are true, correct and complete.

State of Arizona)
County of Maricopa)

On this 8 Day of September, 20 17 before me personally appeared Ryan Witner Anderson
Day Month Year (Print Name of Document Signer)

Whose identity was proven to me on the basis of satisfactory evidence to be the person who he or she claims to be and acknowledged that he or she signed the above/attached document.

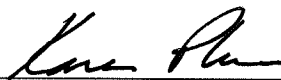

Signature of NOTARY PUBLIC

GOVERNING BOARD

After completion, and **BEFORE submitting to the Department of Liquor**, please take this application to your local Board of Supervisors, City Council or Designate for their recommendation. This recommendation is not binding on the Department of Liquor.

☐ Approval ☐ Disapproval

Authorized Signature

Title

Agency

Date

DLLC USE ONLY

Investigation Recommendation: ☐ Approval ☐ Disapproval by: _____ Date: ____/____/____

Director Signature required for Disapprovals: _____ Date: ____/____/____

AS FILED ON 2/15/2011

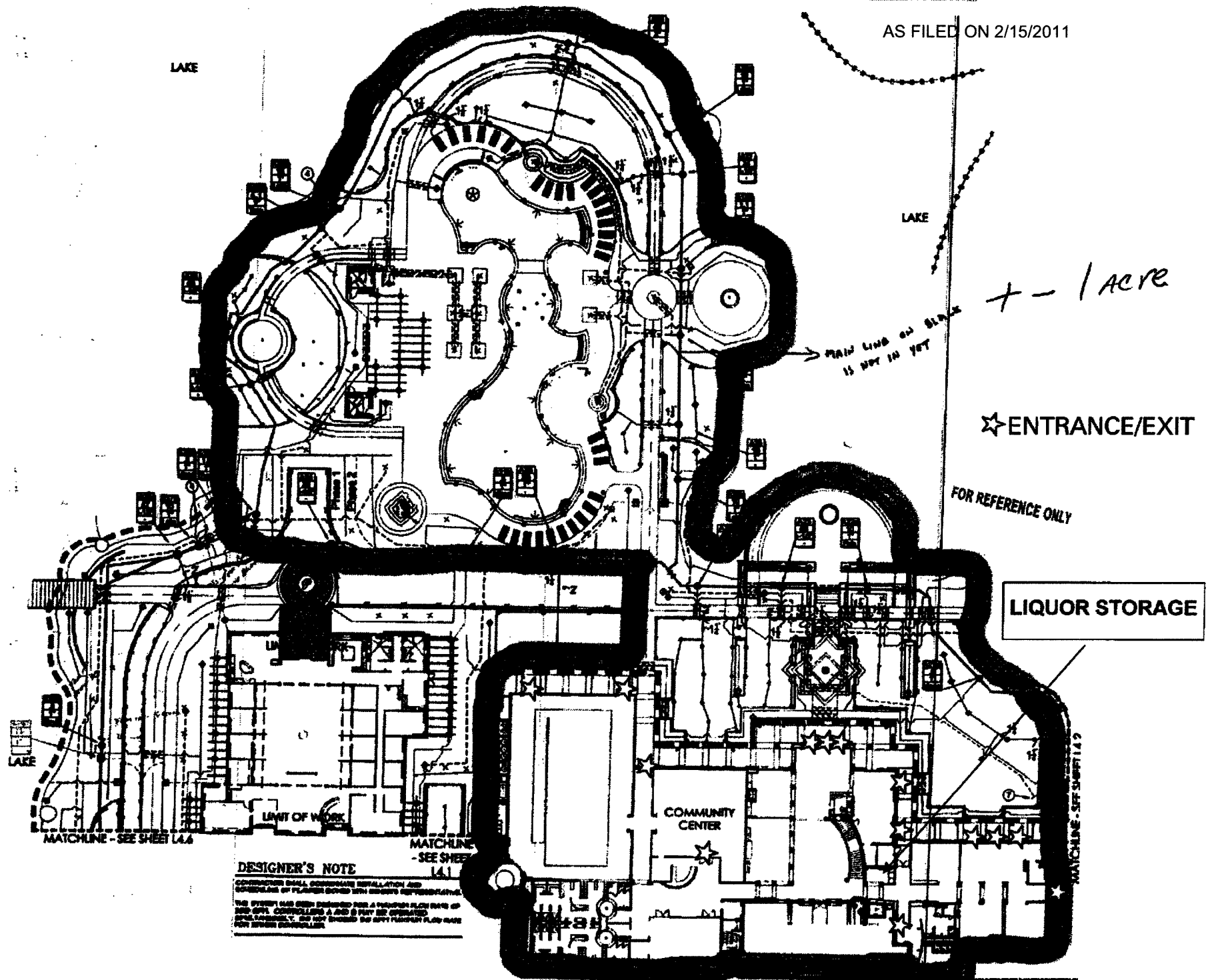

DESIGNER'S NOTE

CONSTRUCTION SHALL BE COMPLETED INSTALLATION AND
COMPLETION OF PLUMBING WORK WITH EXISTING SUPERSTANDARD
THE SYSTEM HAS BEEN DESIGNED FOR A FUTURE PLUMBING OF
AND CITY CONTROLS AND A AND B THAT ARE OPERATED
AND MANUALLY. AND NOT EXCEED THE CITY PLUMBING PLAN HAVE
FOR EXISTING CONSTRUCTION

Original boundary
(inside heavy black line)

EXTENSION OF PREMISES DIAGRAM

(entire premises now
+/- 1.5 acres)

New licensed premises boundary
(inside blue line)

LIQUOR STORAGE

2nd floor
(see
attached
detail)

(building #1)
COMMUNITY
CENTER

building #2
(see attached detail)

Extended area
boundary
(inside green area)

MATCHLINE - SEE SHEET L4

LAKE

11 FEB 15 10:41 AM 2023

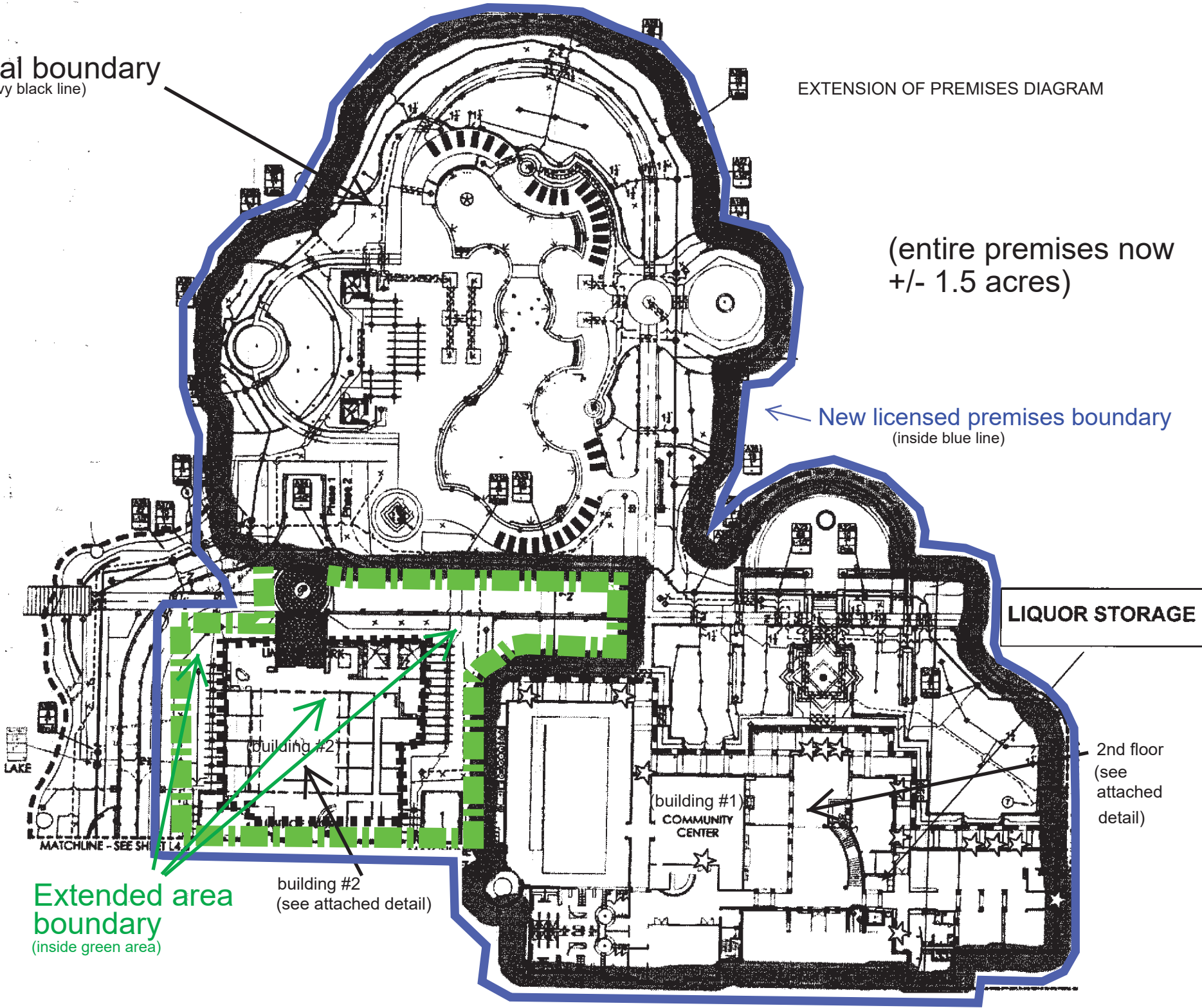

hol

Entrance/exit

HOSPITALITY AREA

RECEPTION CENTER

MEETING ROOM

STORAGE

CONFERENCE

OFFICE

RECEPTION

236

237

Entrance/exit

(Entire premises licensed
for alcohol storage, sales,
display and consumption)

non-primary
entrance/exit