

EXHIBIT A

**LEGAL DESCRIPTION
FOR PARCEL 9.1- ESTRELLA RANCH**

That portion of a parcel of land described as Parcel No. 10 in Document # 2005-0643150 of the Maricopa County Recorder lying within the Southwest Quarter of Section 26 and the Southeast Quarter of Section 27, Township 1 South, Range 2 West of the Gila and Salt River Meridian in Maricopa County, Arizona, being more particularly described as follows:

COMMENCING at the General Land Office (GLO) brass cap found at the Section Corner common to Sections 26, 27, 34, and 35, from which the GLO brass cap found at the South Quarter Corner of said Section 27 bears South 88 degrees 50 minutes 56 seconds West a distance of 2,730.94 feet, said line being the South line of said Southeast Quarter of said Section 27 and the basis of bearings of this description;

Thence along the Section line common to said Section 26 and 27, North 00 degree 25 minutes 50 seconds West a distance of 1,514.90 feet to the POINT OF BEGINNING;

Thence North 88 degrees 49 minutes 01 seconds West a distance of 758.80 feet to a point on the east property line of "Coronado Village at Estrella Mountain Ranch Parcel 9.2" as found in Book 856 of Maps, Page 29 of the Maricopa County Recorder;

Thence along said east property line, North 01 degree 11 minutes 15 seconds East a distance of 734.00 feet to a point on the south property line of "Montecito Village at Estrella Mountain Ranch Parcel 7.14" as found in Book 1053 of Maps, Page 50 of the Maricopa County Recorder;

Thence along said south property line, South 88 degrees 48 minutes 44 seconds East a distance of 158.65 feet to a point;

Thence continuing along said south property line, South 36 degrees 25 minutes 44 seconds East a distance of 6.33 feet to a point;

Thence continuing along said south property line, South 88 degrees 50 minutes 11 seconds East a distance of 72.62 feet to a point;

Thence continuing along said south property line, North 01 degree 09 minutes 49 seconds East a distance of 115.17 feet to a point;

Thence continuing along said south property line, North 73 degrees 15 minutes 57 seconds East a distance of 350.02 feet to a point;

Thence continuing along said south property line, South 46 degrees 28 minutes 51 seconds East a distance of 107.06 feet to a point;

Thence continuing along said south property line, North 51 degrees 06 minutes 19 seconds East a distance of 349.76 feet to a point on the East-West mid-section line of said Section 26;

Thence along said East-West mid-section line, South 88 degrees 34 minutes 22 seconds East a distance of 143.24 feet to a point on the west right-of-way line of Estrella Parkway as defined on "Estrella Parkway Phase 3 Map of Dedication" found in Book 771 of Maps, Page 9 of the Maricopa County Recorder, said point also being on a non-tangent curve to left being concave Easterly and having a radius of 3060.00 feet bearing South 84 degrees 44 minutes 06 seconds East;

Thence along said west right-of-way line and said curve, through a central angle of 20 degrees 55 minutes 20 seconds an arc distance of 1117.40 feet to a point;

Thence North 88 degrees 49 minutes 01 seconds West a distance of 422.86 feet to the POINT OF BEGINNING.

Said parcel containing 997,986 SQUARE FEET or 22.911 ACRES, more or less.



ESTRELLA RANCH- PARCEL 9.1
BOUNDARY CLOSURE

Polyline Report

Thu Apr 13 08:01:13 2017

Northing	Easting	Bearing	Distance
340430.189	541640.469		
		N 88°49'01" W	758.802
340445.854	540881.828		
		N 01°11'15" E	734.000
341179.697	540897.041		
		S 88°48'44" E	158.652
341176.408	541055.659		
		S 36°25'44" E	6.332
341171.313	541059.420		
		S 88°50'11" E	72.620
341169.839	541132.025		
		N 01°09'49" E	115.170
341284.985	541134.364		
		N 73°15'57" E	350.020
341385.767	541469.560		
		S 46°28'51" E	107.060
341312.046	541547.194		
		N 51°06'19" E	349.760
341531.657	541819.413		
		S 88°34'22" E	143.240
341528.090	541962.609		
Radius: 3060.000 Chord: 1111.197 Degree: 1°52'21" Dir: Left			
Length: 1117.395 Delta: 20°55'20" Tangent: 564.989			
Chord BRG: S 05°11'46" E Rad-In: S 84°44'06" E Rad-Out: N 74°20'34" E			
Radius Point: 841247.290, 545009.698			
340421.459	542063.242		
		N 88°49'01" W	422.863
340430.189	541640.469		

Closure Error Distance> 0.00000

Total Distance> 4335.915

Polyline Area: 997985.5 sq ft, 22.9106 acres

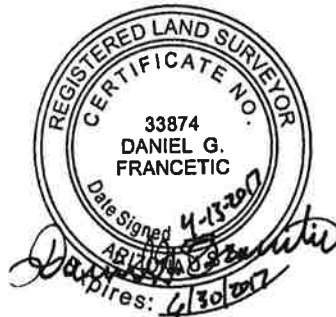

ESTRELLA RANCH- PARCEL 9.1
TIE LINE

Polyline Report

Thu Apr 13 08:12:09 2017

Northing	Easting	Bearing	Distance
838915.332	541651.853		
		N 00°25'50" W	1514.900
840430.189	541640.469		

Closure Error Distance> 1514.89963 Error Bearing> S 00°25'50" E
Closure Precision> 1 in 1.0 Total Distance> 1514.900
Area not calculated because polyline not closed

