

## Proposed Dynamic Message Signs

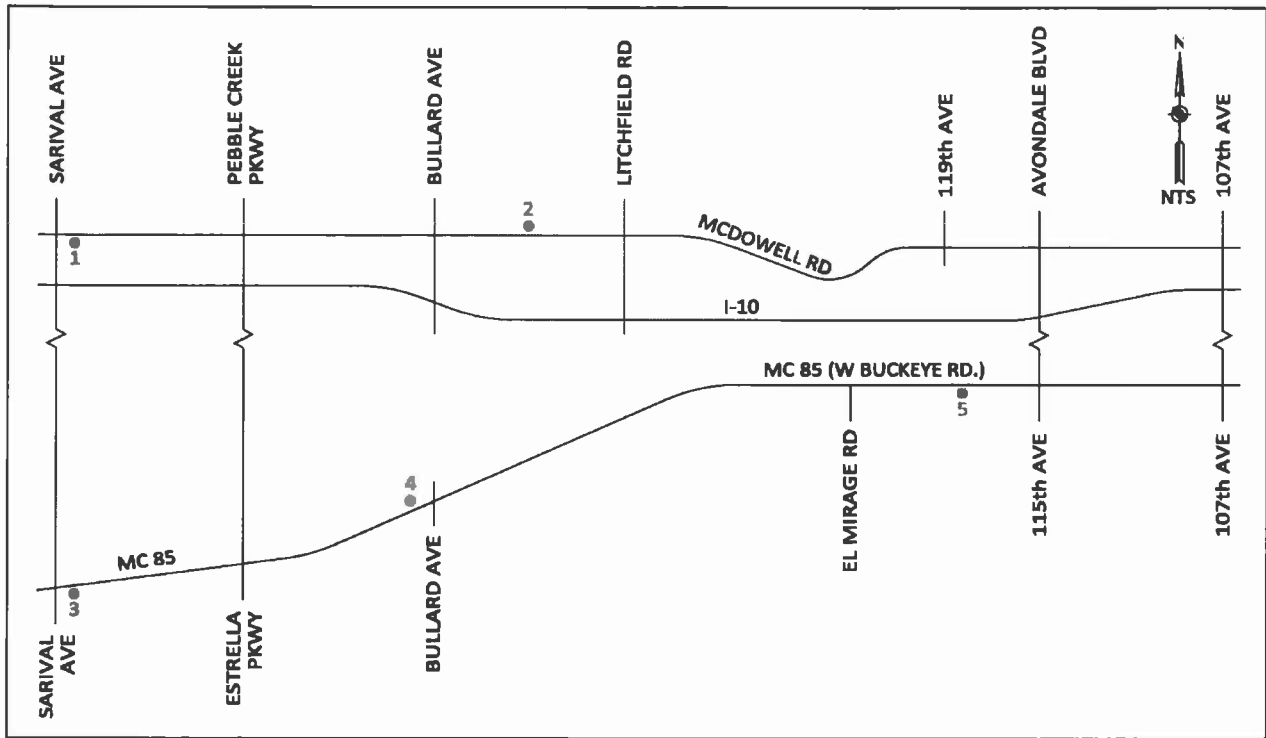

Five DMSs are proposed to be installed at the following locations:

1. McDowell Road (eastbound traffic west of Pebble Creek Parkway/Estrella Parkway)
2. McDowell Road (westbound traffic east of Bullard Avenue)
3. MC 85 (eastbound traffic west of Estrella Parkway)
4. MC 85 (westbound traffic east of Estrella Parkway)
5. MC 85 (eastbound traffic west of Avondale Boulevard)