

- B - BUSINESS: BASIC METALS OFFICES
- F-2 - FACTORY: BASIC METAL
- S-1 - STORAGE: BASIC METAL
- B - BUSINESS: SWORD OF THE SPIRIT MINISTRY'S OFFICES
- ACCESSORY: SWORD OF THE SPIRIT MINISTRY AISLE
- A-3 - ASSEMBLY: SWORD OF THE SPIRIT MINISTRY NON-FIXED SEATING
- STAGE: SWORD OF THE SPIRIT MINISTRY DESIGNATED FLOOR AREA

**6 LEGEND AND CODE DATA**

**OCCUPANCY LOAD - PER 2012 I.B.C. TABLE 1004.1.1**

<b>BASIC METALS:</b>		
B - BUSINESS :	1,282 S.F.	
F-2 - FACTORY :	7,064 S.F.	
S-1 - STORAGE :	11,206 S.F.	
<b>TOTAL BASIC METALS:</b>	<b>19,552 S.F.</b>	
<b>SWORD OF THE SPIRIT MINISTRY:</b>		
ACCESSORY CIRCULATION:	1,969 S.F.	
STAGE:	684 S.F.	
A-3 - ASSEMBLY NON-FIXED SEATING:	400 S.F.	
B - BUSINESS :	3,247 S.F.	
<b>TOTAL SWORD OF THE SPIRIT MINISTRY:</b>	<b>6,300 S.F.</b>	
<b>BUILDING TOTAL:</b>		
BASIC METALS:	19,552 S.F.	
SWORD OF THE SPIRIT MINISTRY:	6,300 S.F.	
<b>TOTAL SWORD OF THE SPIRIT MINISTRY:</b>	<b>25,852 S.F.</b>	
<b>BASIC METALS:</b>		
B - BUSINESS :	1,282 S.F. / 100 = 13	
F-2 - FACTORY :	7,064 S.F. / 100 = 71	
S-1 - STORAGE :	11,206 S.F. / 500 = 23	
<b>TOTAL BASIC METALS:</b>	<b>107</b>	
<b>SWORD OF THE SPIRIT MINISTRY:</b>		
ACCESSORY CIRCULATION:	1,969 SF / 0 = 0	
STAGE:	684 SF / 15 = 46	
A-3 - ASSEMBLY NON-FIXED SEATING:	214 + 196 = 400 SF / 7 = 56	
B - BUSINESS :	2,151 + 958 + 138 = 3,247 SF / 100 = 33	
<b>TOTAL SWORD OF THE SPIRIT MINISTRY:</b>	<b>136</b>	

**12 OCCUPANY AREAS**

**PLUMBING FIXTURE CALCULATIONS**  
FIXTURE CALCULATIONS ARE FIGURED FOR THE ENTIRE BUILDING.

OCCUPANCY TYPE	OCCUPANT LOAD			WATER CLOSETS			LAVATORIES		
	TOTAL	M	F	MIN. REQ.	M	F	MIN. REQ.	M	F
GROUP B OFFICE	13	6.5	6.5	1.25	0.26	0.26	1.40	0.16	0.16
GROUP F-1 OFFICE	71	35.5	35.5	1:100	0.36	0.36	1:100	0.36	0.36
GROUP S-1 OFFICE	23	11.5	11.5	1:100	0.12	0.12	1:100	0.12	0.12
<b>TOTAL REQUIRED</b>					1	1		1	1
<b>TOTAL PROVIDED</b>					4	4		2	2
<b>SERVICE SINKS</b>					REQUIRED	1	PROVIDED	1*	
<b>DRINKING FOUNTAINS 1:1000</b>					REQUIRED	1	PROVIDED	1**	

OCCUPANCY TYPE	OCCUPANT LOAD			WATER CLOSETS			LAVATORIES		
	TOTAL	M	F	MIN. REQ.	M	F	MIN. REQ.	M	F
GROUP B OFFICE	33	16.5	16.5	1.25	0.66	0.66	1.40	0.41	0.41
GROUP A-3 ASSEMBLY, PLACES OF WORSHIP	56	28	28	1:150 M 1:75 W	0.37	0.75	1:200	0.28	0.28
STAGE	46	23	23	1:150 M 1:75 W	0.15	0.31	1:200	0.12	0.12
ACCESSORY CIRCULATION	0	0	0	0	0	0	0	0	0
<b>TOTAL REQUIRED</b>					1.18	1.72		0.81	0.81
<b>TOTAL PROVIDED</b>					2	2		1	1
<b>SERVICE SINKS</b>					REQUIRED	1	PROVIDED	1*	
<b>DRINKING FOUNTAINS 1:1000</b>					REQUIRED	1	PROVIDED	1**	

\* 1 SERVICE SINK FOR THE BUILDING. UNDER A SIGNED SHARED USE AGREEMENT, THE SERVICE SINK WILL BE AVAILABLE TO BASIC METALS MONDAY THROUGH FRIDAY, AND TO SWORD OF THE SPIRIT MINISTRY ON SUNDAYS.  
 \*\* 1 HI-LO DRINKING FOUNTAIN IS AVAILABLE TO BASIC METALS MONDAY THROUGH FRIDAY. A 5 GALLON BOTTLED WATER DISPENSER WILL BE AVAILABLE FOR SWORD OF THE SPIRIT MINISTRY, WITHIN THE BREAK ROOM WITHIN THEIR SUITE, ON SUNDAYS.

**ARCHICON**  
Architecture & Interiors, L.C.  
5055 E WASHINGTON STREET  
SUITE 200  
PHOENIX, ARIZONA 85034  
(602) 222-4266  
FAX (602) 279-4305  
www.ARCHICON.COM

**SWORD OF THE SPIRIT MINISTRY**  
TENANT IMPROVEMENTS  
15635 WEST ILLINI STREET  
GOODYEAR, ARIZONA 85338

PROJECT NUMBER: 1875255-01  
PROJECT MANAGER: PS  
DRAWN BY: PMN  
CHECKED BY: TR

NO.	REVISION	DATE

SHEET DESCRIPTION  
FLOOR PLAN - OCCUPANCY

JERE W. PLANK  
REGISTERED PROFESSIONAL ENGINEER  
ARIZONA, U.S.A.  
EXPIRES: 12/31/2018

SHEET NO.

**A0.2**

ISSUE DATE: 08/24/2018

**19 FLOOR PLAN - OCCUPANCY**

**24 PLUMBING CALCULATIONS**

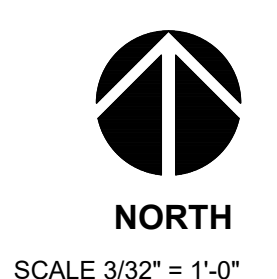

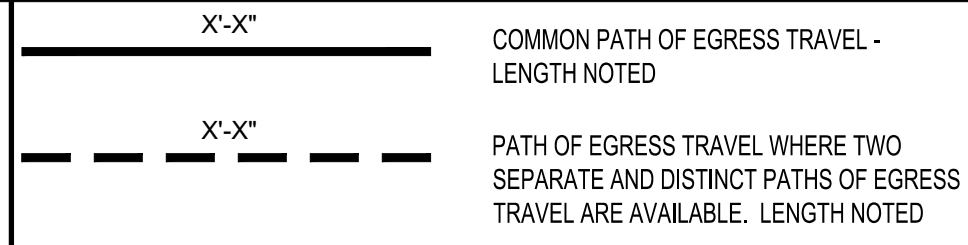
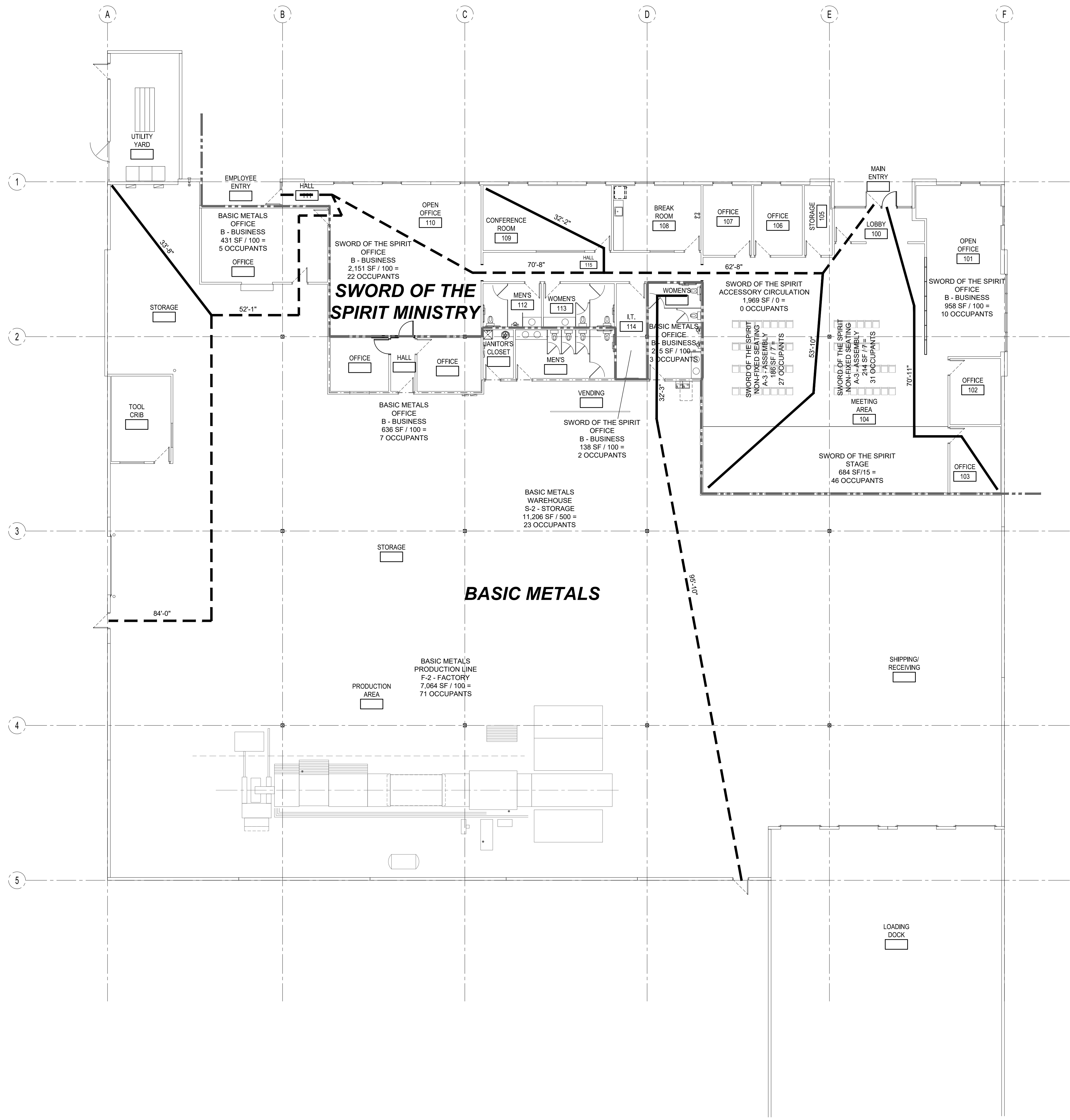

**TOTAL BUILDING AREA:**  
 BUILDING : 25,902 S.F.

**PROJECT AREA:**  
 SWORD OF THE SPIRIT MINISTRY SUITE: 6,370 S.F.  
 BASIC METALS SUITE: 19,532 S.F.

**OCCUPANCY TYPE:**  
 SWORD OF THE SPIRIT MINISTRY SUITE: B BUSINESS (OFFICE)  
 A-3 ASSEMBLY NON-FIXED SEATING ACCESSORY CIRCULATION STAGE

**BASIC METALS SUITE:**  
 F-1 MANUFACTURING (SHEET METAL MANUFACTURING)  
 S-1 WAREHOUSE (PRODUCT WAREHOUSING)  
 B (OFFICE)

**CONSTRUCTION TYPE:**  
 V-B, AFES

**OCCUPANCY LOAD - PER I.B.C.**

**SWORD OF THE SPIRIT MINISTRY:**  
 ACCESSORY CIRCULATION: 1,969 S.F.  
 STAGE: 684 S.F.  
 A-3 - ASSEMBLY NON-FIXED SEATING: 400 S.F.  
 B - BUSINESS : 3,247 S.F.  
 TOTAL SWORD OF THE SPIRIT MINISTRY: 6,300 S.F.

**BASIC METALS:**  
 B - BUSINESS : 1,282 S.F.  
 F-2 - FACTORY : 7,064 S.F.  
 S-1 - STORAGE : 11,206 S.F.  
 TOTAL BASIC METALS: 19,552 S.F.

**BASIC METALS:**  
 B - BUSINESS : 1,282 S.F. / 100 = 13  
 F-2 - FACTORY : 7,064 S.F. / 100 = 71  
 S-1 - STORAGE : 11,206 S.F. / 500 = 23  
 TOTAL BASIC METALS: 107

**SWORD OF THE SPIRIT MINISTRY:**  
 ACCESSORY CIRCULATION: 1,969 SF / 0 = 0  
 STAGE: 684 SF / 15 = 46  
 A-3 - ASSEMBLY NON-FIXED SEATING: 214 + 186 = 400 SF / 7 = 56  
 B - BUSINESS : 2,151 + 958 + 138 = 3,247 SF / 100 = 33  
 TOTAL SWORD OF THE SPIRIT MINISTRY: 136

**EXITS (PER I.B.C.)**  
 REQUIRED: 1  
 PROVIDED: 4

**FIRE ALARM SYSTEM:** EXISTING TO REMAIN UNCHANGED

**FIRE SPRINKLER SYSTEM:** EXISTING TO REMAIN UNCHANGED

**IBC:**

**TABLE 1014.3 COMMON PATH OF EGRESS TRAVEL:**  
 B OCCUPANCY - EQUIPPED THROUGHOUT WITH AUTOMATIC FIRE SPRINKLERS = 100'-0" MAX

**SECTION 1015.2.1 TWO EXITS OR EXIT ACCESS DOORWAYS**  
 WHERE TOW (2) EXITS ARE REQUIRED, A SEPARATION OF NOT LESS THAN 1/2 THE DIAGONAL DISTANCE OF SPACE/BUILDING IS REQUIRED.

**(EXCEPTION 2: DIAGONAL IS REDUCED TO 1/3 THE DISTANCE OF AREA SERVED IF BUILDING IS EQUIPPED THROUGHOUT WITH AUTOMATIC FIRE SPRINKLERS)**

**TABLE 1016.2 EXIT ACCESS TRAVEL DISTANCE:**  
 GROUP B OCCUPANCY WITH AUTOMATIC FIRE SPRINKLERS = 300'-0"

**(18) LEGEND AND CODE DATA**

MAXIMUM ACTUAL COMMON PATH OF TRAVEL = 95'-10"

MAXIMUM ACTUAL EXIT ACCESS TRAVEL DISTANCE = 128'-1"

EXIT SEPARATION DISTANCE: (226'-0" / 3) = 75'-4" (122'-0" ACTUAL)

**ARCHICON**  
 Architecture & Interiors, L.C.  
 5055 E WASHINGTON STREET  
 SUITE 200  
 PHOENIX, ARIZONA 85034  
 (602) 222-4266  
 FAX (602) 279-4305  
 www.ARCHICON.COM

**SWORD OF THE SPIRIT MINISTRY**  
 TENANT IMPROVEMENTS  
 15635 WEST ILLINI STREET  
 GOODYEAR, ARIZONA 85338

PROJECT NUMBER: 1875255-01  
 PROJECT MANAGER: PS  
 DRAWN BY: PMN  
 CHECKED BY: TR

NO.	REVISION	DATE

SHEET DESCRIPTION  
 EGRESS PLAN

EXPIRES: 12/31/2018

SHEET NO.

**A0.3**

ISSUE DATE: 08/24/2018

